

Brick tray

T section range Soldier or Gauged brick 290 mm high

Section at span

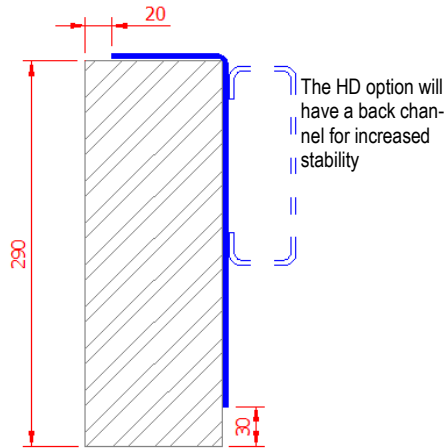

Section at bearing

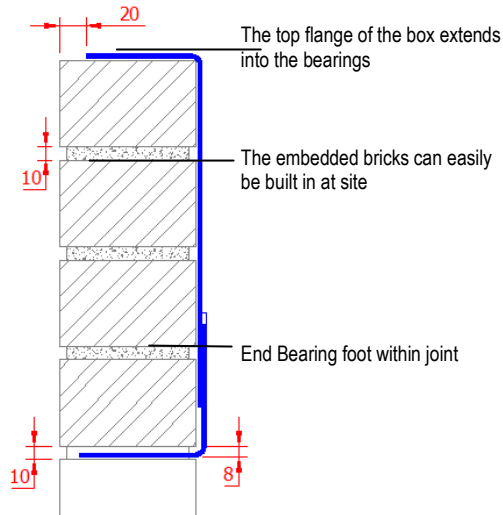

T290/3

Lintel section properties

lxx	763 cm ⁴
Zxx	47.38 cm ³
Weight	8.13 kg/m
Area	10.17 cm
Ryy	1.98 cm

T290/4

Lintel section properties

lxx	1024 cm ⁴
Zxx	63.40 cm ³
Weight	10.80 kg/m
Area	13.59 cm
Ryy	2.00 cm

T290/6

Lintel section properties

lxx	1599 cm ⁴
Zxx	97.00 cm ³
Weight	16.70 kg/m
Area	20.91 cm
Ryy	2.20 cm

T290/4-HD

Lintel section properties

lxx	1323 cm ⁴
Zxx	72.00 cm ³
Weight	18.30 kg/m
Area	22.89 cm
Ryy	2.90 cm

Lintel load Capacity Table

Opening Span	Lintel Length	Safe Load kN
600	900	72.6
900	1200	48.4
1200	1500	36.3
1500	1800	29.1
1800	2100	24.2
2100	2400	20.8
2400	2700	18.2
2700	3000	16.1
3000	3300	14.5

Lintel load Capacity Table

Opening Span	Lintel Length	Safe Load kN
600	900	97.2
900	1200	64.8
1200	1500	48.6
1500	1800	38.9
1800	2100	32.4
2100	2400	27.8
2400	2700	24.3
2700	3000	21.6
3000	3300	19.4
3300	3600	17.7

Lintel load Capacity Table

Opening Span	Lintel Length	Safe Load kN
600	900	148.7
900	1200	99.2
1200	1500	74.4
1500	1800	59.5
1800	2100	49.6
2100	2400	42.5
2400	2700	37.2
2700	3000	33.1
3000	3300	29.7
3300	3600	27.0
3600	3900	24.8
3900	4200	22.9

Lintel load Capacity Table

Opening Span	Lintel Length	Safe Load kN
600	900	110.4
900	1200	73.6
1200	1500	55.2
1500	1800	44.2
1800	2100	36.8
2100	2400	31.5
2400	2700	27.6
2700	3000	24.5
3000	3300	22.1
3300	3600	20.1
3600	3900	18.4

The section provides a bearing on the top flange with a second bearing at the "foot". The bricks at the bearing also fully fill between the top and bottom bearing.

Loadings are shown above to assist you in your selection 102.5mm brickwork is 2.2 kN/m² 215mm dimensions can be varied to suit imperial and other brick sizes